

NC 135 WW

Architectural Envelope Window Wall

Manufactured and Distributed by:



40 Murphy Drive, Avon, MA 02322

Tel: 508-588-4845 • 800-498-4845

Fax: 508-587-3939

www.archglazing.com

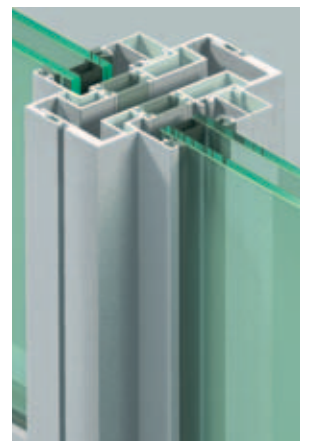

NC 135 WW



Features

- 6063-T5 Aluminum Alloy Frame
- Shop Glazing
- Frame Depth 135 mm [5 3/8"]
- Captured Glazing
- Various Glass Size
- Weather Stripping: EPDM Gaskets
- Thermal Barrier: Polyamide
- Straight Cut 90° fastening with screws
- Custom Color
- Painted or Anodized Finish
- Dual Finish Available
- Durable Components

Benefits

- Quick Installation from inside
- Acoustic Insulation
- Thermal Insulation
- Quiet and Smooth Closing System
- Easy Maintenance
- Easy Glass Replacement

Applications

- Low, Mid, and High-Rise Buildings
- Storefronts

Technology

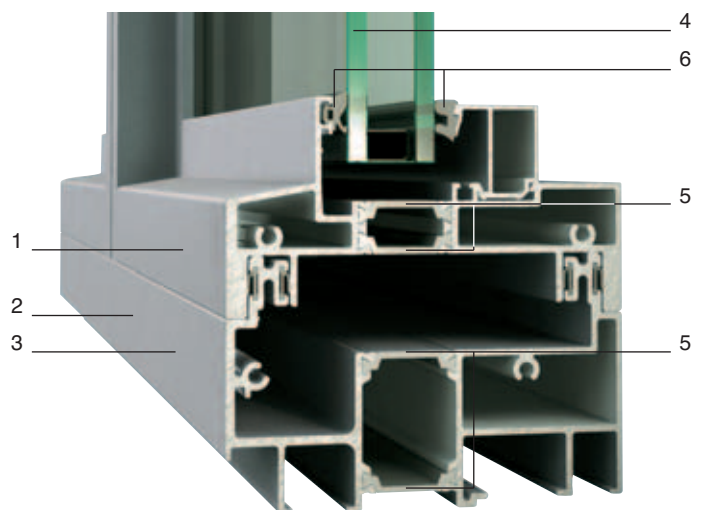

- 1- Pre-Assembled Module
- 2- Gutter
- 3- Painted or Anodized Finish
- 4- Insulating Glass Unit
- 5- Polyamidic Thermal Barrier
- 6- EPDM Gaskets

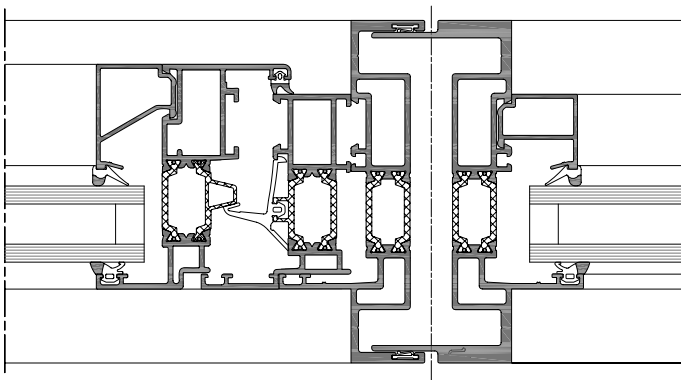

Horizontal Section
Operable-Fixed

Performance data

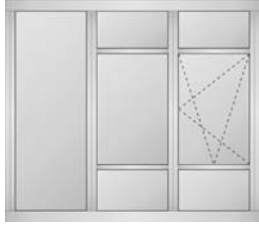
Tested Configuration	Specimen Size	AAMA / ASTM TEST PROCEDURES	
 <p>NC 135 WW</p>	<p>DP 65 Window Wall</p> <p>3680 x 3048 mm [115" x 120"]</p>	Air tightness @ 75 Pa [1.57 psf]	Air tightness @ 300 Pa [6.27 psf]
		Q_{average} : 0.23 L/s.m ² [0.045 ft ³ /min-ft ²]	Q_{average} : 0.46 L/s.m ² [0.091 ft ³ /min-ft ²]
		Static water penetration: ASTM E 331	
		DP 100: 720 Pa [15 psf]	
		Dynamic water penetration: AAMA 501.1	
		No water infiltration under a differential pressure of 720 Pa [15 psf]	
		Structural: ASTM E 330	
		DP 65 - Blow-out pressure: 4668 Pa [97.5 psf]	

Opening Solutions

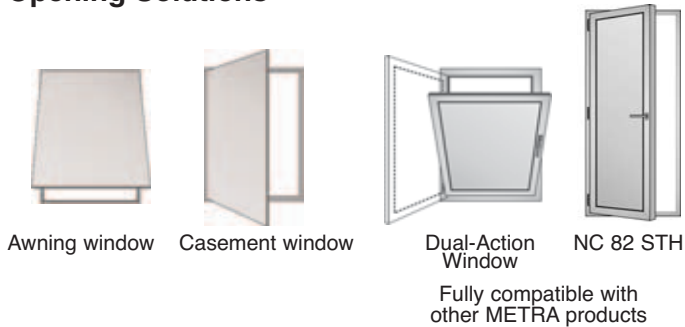

Quality

METRA stands for quality and optimal performance. Only original METRA profiles and accessories can certify the highest performance. Original METRA products have an "M" mark on the interior surface.

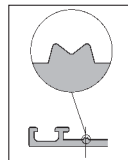

METRA quality is certified by ISO 9001. METRA controls the entire process of production for the extrusions. Manufacturing and installation of final products are performed through a network of independent specialists.



Manufactured and Distributed by:



40 Murphy Drive, Avon, MA 02322
Tel: 508-588-4845 • 800-498-4845
Fax: 508-587-3939
www.archglazing.com



METRA Systems
1995 Industrial Blvd. - Laval, QC H7S 1P6, Canada
Tel. +1 450 629 4260 - Fax +1 450 629 7313
info@metrasystem.com
www.metrasystem.com



METRA
METRA S.p.A.
Via Stacca, 1 - 25050 Rodengo Saiano (BS) Italy
Tel. +39 030 6819.1 - Fax +39 030 6819 990
metra@metra.it
www.metra.eu

METRA Products

Architectural Envelope

Entrances & Windows

Special Systems

Sliding Systems

Accessories

Printed in September 2009